

MODEL 129, 140, 170, 202, 203, 208, 209.3 /4, 210

Models 129, 140 as of 1.11.93, 170, 202, 203, 208, 209, 210

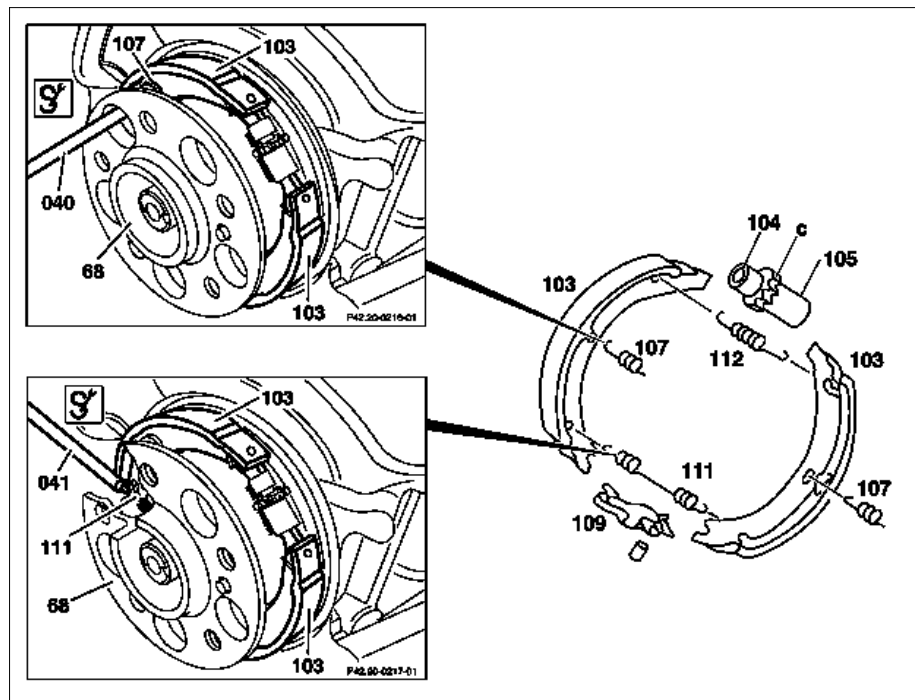

P42.20-0215-06

Model 140 up to 31.10.93

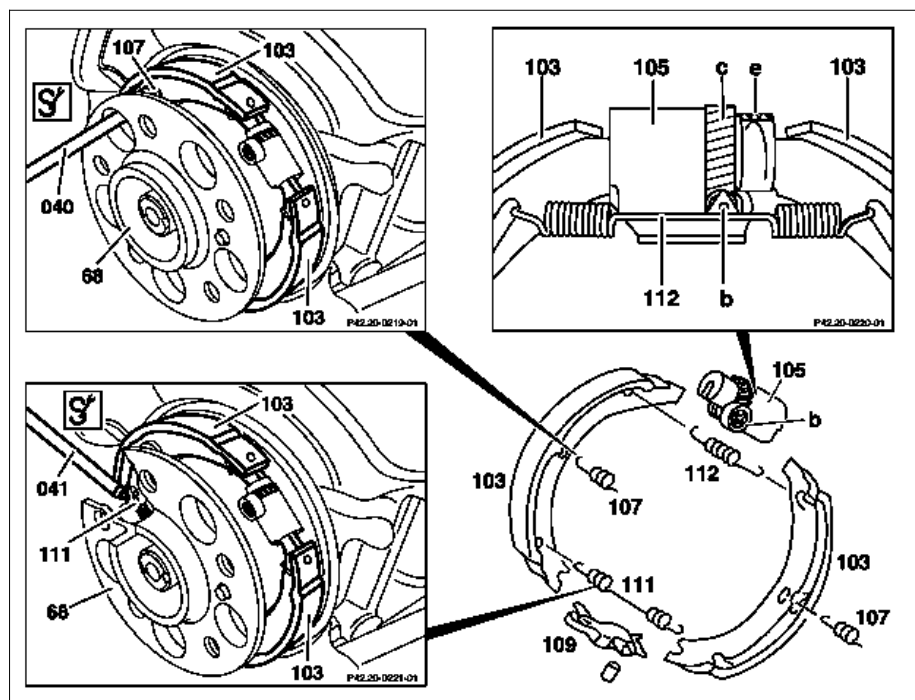





P42.20-0218-06

Modification notes

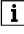
12.12.02	Safety note for lifting platform, added		AS00.00-Z-0010-01A
12.12.02	Check version of pedal assembly, added	Step 12	BT42.20-P-0510-01A

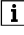
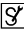
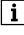
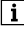
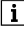
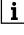
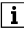
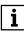
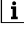
	Remove/install		
Danger!	Risk of death caused by vehicle slipping or toppling off of the lifting platform.	Align vehicle between columns of vehicle lift and position four support plates at vehicle lift support points specified by vehicle manufacturer.	AS00.00-Z-0010-01A
1 AP	Remove rear wheels Remove/install wheels, rotate if necessary		AP40.10-P-4050Z
2	Remove brake disks on rear axle	Model 129, 140, 170, 202, 208, 210 Model 203, 209 except 209.376/ 476 as of 24.4.04, 209.377, 209.477	AR42.10-P-0220A AR42.10-P-0220P

		Model 209.376/ 476 as of 24.4.04, 209.377, 209.477 Model 209.308/ 320/ 354/ 356/ 420/ 454/ 456/	AR42.10-P-0220AC
3.1	Fold forward and remove rear seat cushion	Vehicles without code P98 Black Series	
3.2	Remove battery	Vehicles with code P98 Black Series	AR54.10-P-0005P
4.1	Remove cover panel under rear seat cushion	Vehicles without code P98 Black Series	
4.2	Remove cover panel under battery	Vehicles with code P98 Black Series	
4.3	Remove heat shield of exhaust system	Model 129, 140	
5.1	Preloading automatic cable slack adjuster	Model 140 Model 202, 208, 210	AR42.20-P-0520-01A AR42.20-P-0520-01B
5.2	Release adjustable cable slack adjuster	See Remove/install rear brake cable: Model 129, 170 Model 203, 209	AR42.20-P-0525A AR42.20-P-0525P
6	Unhook retracting spring (111) using removal and installation tool (041)	 Installation: Make sure that the retracting spring (111) is seated correctly. 	*116589016200
7	Unhook retaining springs (107) using installation tool (040)	 Installation: Make sure that the retaining springs (107) are seated correctly. 	*112589096100
8	Remove brake shoes (103) over rear axle shaft flange (68)	 If the brake shoes (103) are burnt, the brake shoes (103), retracting springs (111, 112) and retaining springs (107) must be replaced. On vehicles with internally ventilated brake disks, the brake disks must also be replaced. Models 129, 140 as of 1.11.93, 170, 202, 203, 208, 209, 210:  Installation: Turn back adjusting mechanism (105) and insert into both brake shoes (103) with the adjusting wheel (c) pointing toward front of vehicle. Model 140 up to 31.10.93  Installation: Turn back the adjusting mechanism (105) and insert into both brake shoes (103) so that the flat area on the adjusting screw (e) is pointing upward. The adjusting screw (e) must point in the direction of travel on the left-hand side and toward the rear on the right-hand side.	
9	Detach retracting spring (112)	Models 129, 140 as of 1.11.93, 170, 202, 203, 208, 209, 210:  Coat the thread of the thrust piece (104) and the cylindrical part of the adjustment wheel (c) with MB long-life grease. Model 140 up to 31.10.93  Rub MB long-life grease into the thread of the bolt (b) and adjustment wheel (c).  Installation: The retracting spring (112) must be underneath the bolt (b). Make sure that the retracting spring (112) is seated correctly. Long-life grease	*BR00.45-Z-1001-06A
10	Remove expansion lock (109)	 Coat all bearing and slide surfaces at the expansion lock (109) with MB long-term grease. Long-life grease	*BR00.45-Z-1001-06A
11	Install in the reverse order		
12.1	Release automatic slack adjuster	Model 140, 202, 208, 210	AR42.20-P-0520-02A
12.2	Load adjustable cable slack adjuster	See Remove/install rear brake cable: Model 129, 170 Model 203, 209	AR42.20-P-0525A AR42.20-P-0525P
	Checking		
13  BT	Check version of pedal assembly Parking brake pedal assembly modified	Except model 170	BT42.20-P-0510-01A
14	Adjust parking brake	Models 129, 140 as of 1.11.93, 170, 202, 203, 208, 209, 210 Model 140 up to 31.10.93	AR42.20-P-0540A AR42.20-P-0540B

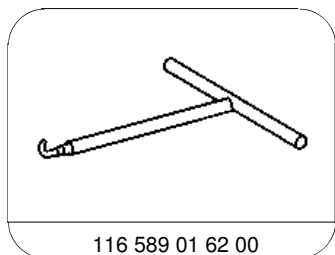

Removal and installation tool

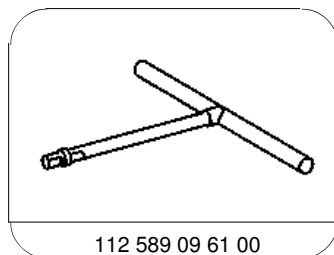

Installation tool

Repair materials

Number	Designation	Order number
BR00.45-Z-1001-06A	Long-life grease	A 000 989 63 51 11